

# Food Allergen Solutions

Choose Neogen



## Reveal® 3-D Test Kits

For the on-site detection of allergen content in food & environmental swabs

### Simple Tools for Food Allergen Control

The Reveal® 3-D Tests make it simple to screen for the presence of low levels of allergens in food products and environmental swabs virtually anywhere. Sample preparation and testing take less than 10 minutes, making them great choices for on-site food allergen control. Each kit contains everything needed (including swabs) to perform 10 single use tests.

### Reveal® 3-D Technology

The unique hand-held device with 3-line readout: a control line confirms the method has been performed successfully and two further lines differentiate low and high levels of detection.

### A Better Way to Test

Rapid screening of food or swabs	⇒	Real time decisions
On-Site control	⇒	No equipment needed
Easy to use	⇒	Dip & test
3-D technology	⇒	Innovative
Suitable for a range of food matrices	⇒	Flexible
Detect low ppm allergen levels	⇒	Aid allergen control

### Meet the Reveal® 3-D Family

Almond	
Casein	
Crustacea	
Egg	
Gluten	
Hazelnut	
<b>NEW!</b> Mustard	
Peanut	
Soy	
<b>NEW!</b> Total Milk	



To place an order, or for more information, contact your local Neogen Europe representative, or visit our web site at [www.neogeneurope.com](http://www.neogeneurope.com)

Neogen Europe Ltd. • The Dairy School • Auchincruive, Ayr, Scotland • KA6 5HW  
Tel: +44 (0)1292 525610 • Fax: +44 (0)1292 525602 • [info\\_uk@neogeneurope.com](mailto:info_uk@neogeneurope.com)

©Neogen Corporation, 2011. AccuScan, Neogen and Reveal are registered trademarks and of Neogen Corporation, Lansing, Mich.

NE1444-0612



## Reveal® 3-D Procedure

**Note: Please read kit instructions completely before performing test.**

### Rinse Sampling



1. Open extraction buffer sachet and add to a sample tube.



2. Add sample to the sample tube.



3. Secure cap and shake for 1 minute.\*

*\*For Gluten and Casein devices an additional buffer is provided, please follow kit extraction procedure.*

### Swab Sampling



1. Open extraction buffer sachet and add to a sample tube.



2. Gather the sample. *For dry surfaces moisten with extraction solution. Do not premoisten for wet surfaces.*

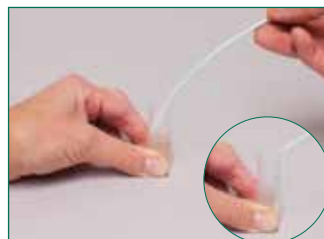

3. Return the swab to the extraction buffer and break off into the tube.



4. Secure cap and shake for 1 minute.\*

*\* For Gluten and Casein devices an additional buffer is provided, please follow kit extraction procedure.*

### Sample Testing



1. Remove the lid and fill with liquid from the tube.



2. Dip the Reveal 3-D device into the liquid in the lid, ensure that the cavity is saturated with the liquid.



3. Leave the cavity saturated until the liquid is seen running into the test window.



4. Place the device on a flat surface and allow the test to develop for 5 minutes.

### Interpret the Results



High Positive



Positive



Negative

**To place an order, or for more information, contact your local Neogen Europe representative, or visit our web site at [www.neogeneurope.com](http://www.neogeneurope.com)**

Neogen Europe Ltd. • The Dairy School • Auchincruive, Ayr, Scotland • KA6 5HW  
Tel: +44 (0)1292 525610 • Fax: +44 (0)1292 525602 • [info\\_uk@neogeneurope.com](mailto:info_uk@neogeneurope.com)

©Neogen Corporation, 2011. AccuScan, Neogen and Reveal are registered trademarks and of Neogen Corporation, Lansing, Mich.

NE1444-0612